



Supplies a wide range of Fibreglass Reinforced Plastic grating and stairtreads. The grating is available in various panel sizes and thicknesses. In this datasheet you will find the main product properties of the grating:

Type: R-13612-MGI3

Product specifications:

Product code:	R-13612-MGI3
Panel size:	3660 x 1220 mm
Mesh size:	38 x 38 mm
Thickness:	13 mm
Resin type:	Isophthalic polyester
Top surface:	Meniscus Top
Colour:	Grey, approximately RAL 7035
Weight grating panel:	27 kg
Surface area panel:	4,5 m ²
Weight:	6 kg/m ²

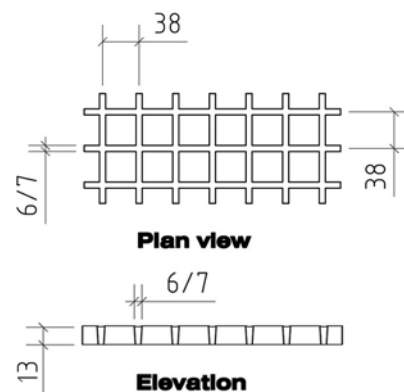

There are also various panel sizes available in the thicknesses: 25, 30, 38 and 50 mm.



Multigrad grating

Multigrad grating is a multi-purpose lightweight Fibreglass Reinforced Plastic grating. The grating is used vertically as screening in and alongside conveyor belts, fencing, air filters, etc. The mesh size of 44 x 44 mm ensures your hands do not fit through it, which makes it a proven safety barrier. Furthermore, when fully supported, the grating can be used horizontally as protection, slip-resistant layer, or pressure distributor; the Meniscus Top ensures that slipping and falling on slippery surfaces is virtually impossible.

www.flexxcon.com

Chemical resistance list

Chemical environment	Concentration %	Temp in °C	ISO
Acetic acid	50	max	C
Alcohols	100	49	I
Ammonium salts-neutral	all	49	C
Ammonium salts-agressive	all	24	I
Chlorine dioxide	saturated	60	N
Chlorine water	saturated	49	I
Citric acid	all	max	C
Crude oil	all	max	C
Ferric chloride	100	max	C
Ferric salts	all	max	C
Fuel (diesel, jet, gasoline)	all	38	C
Hydrochlorid acid	10	max	S
Hydrochlorid acid	30	max	S
Hydrochlorid acid (concentrated)	all	≤83	N
Hydrofluoric acid	20	24	N
Hydrogen peroxide	30	24	N
Lactic acid	100	max	C
Nitric acid	20	49	S
Ozone for sewage treatment		38	C
Phosphoric acid	85	max	C
Phosphoric acid, super	115	max	I
Potassium salts	all	max	C
Sodium hydroxide	50	max	I
Sodium hydroxide	10	max	N
Sodium hypochlorite (stable)	10	38	S
Sodium salt neutral	all	max	C
Sodium sal aggressive	all	24	I
Sulfuric acid	50	max	S
Sulfuric acid	75	38	I
Water (fresh, salt, moderate)	100	max	C

C = Continuous exposure of the grating to the chemical environment at the specified maximum temperature.
 S = Frequent exposure of the grating to splashing and spillage of the chemical environment and temperature as stated in the list.

I = Infrequent exposure of the grating to splashing and spillage of the chemical environment and temperature as stated in the list, and the substances removed from/washed off the grating straight away.

N = Not recommended in the concentrations and temperatures as stated in the list.

Although the greatest care was taken to compile this information, no rights can be derived from it.

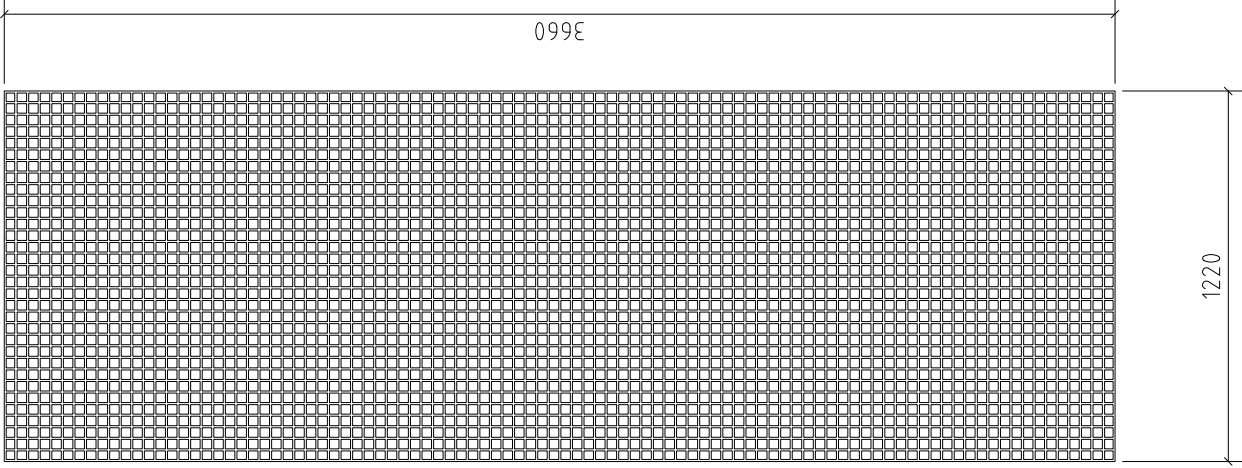

Plan view grating

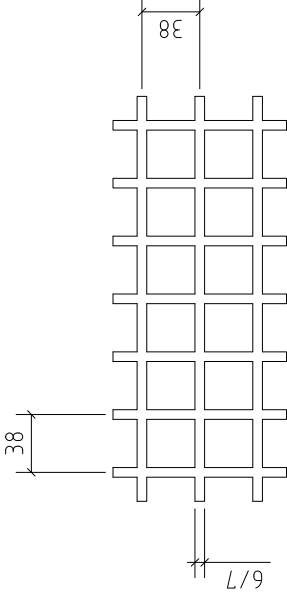

Plan view

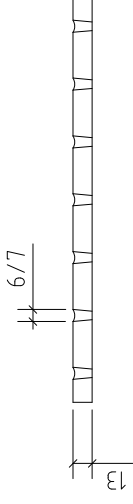

Elevation

Grating size: 3660x1220	Productnumber: R-13612-MG13
Grating height: 13	Drawer: WM
Square Mesh: 38x38	Date:
Weight / m ² : 6 kg	Schale:
Weight per plate: 27 kg	



P.O. Box 1761
 3800 BT Amersfoort
 The Netherlands
 Tel: 0031 (0)33-4556696
 Fax: 0031 (0)33-4553295

Workshop / Warehouse:
 Parallelweg 74
 7161 AG Neede
 The Netherlands